

8000 DIXIE

1.3M square feet
of state-of-the-art
industrial redevelopment.

Discover the infinite advantages.

INDUSTRIAL FOR LEASE | BRAMPTON ON

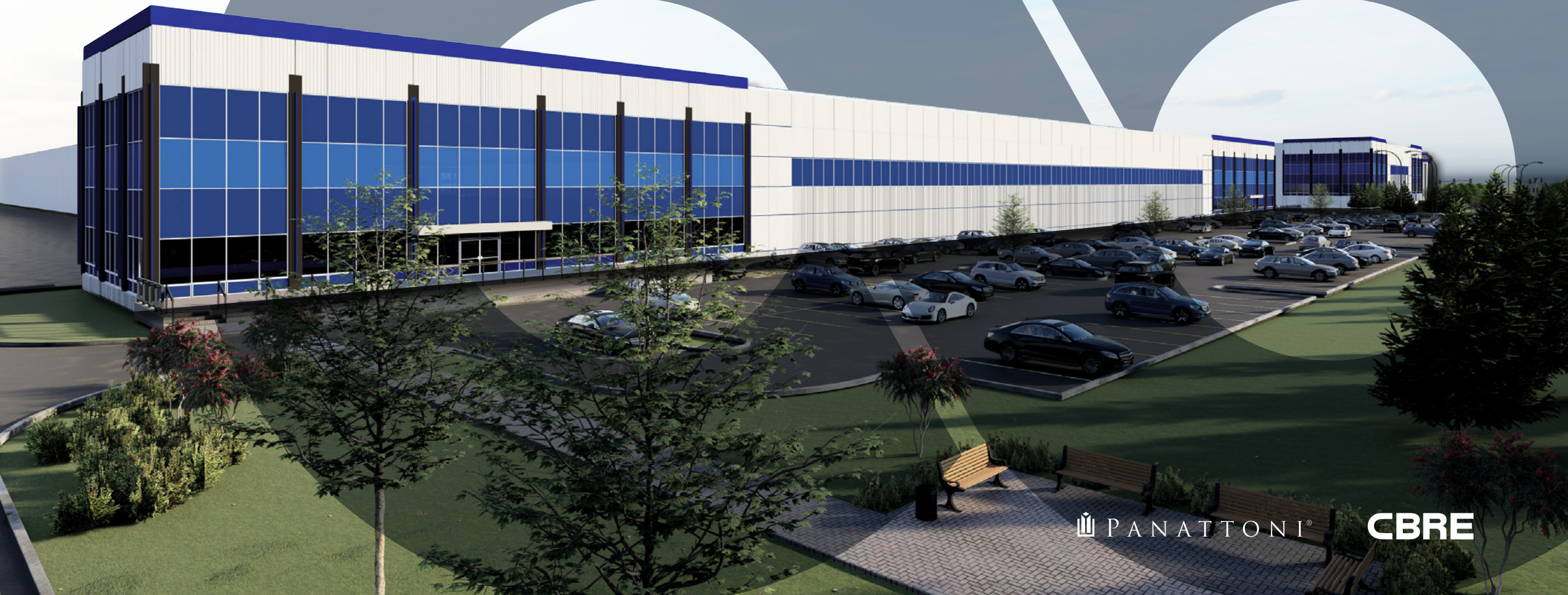

 PANATTONI®

CBRE

WELCOME TO 8000 DIXIE

8000 Dixie is a 1.3M square foot Class A industrial redevelopment project consisting of four state-of-the-art buildings that can accommodate flexible sizes from 75,000 to 570,000 square feet for a wide variety of users. Its strategic infill location in the heart of the industrial node of Brampton, just minutes from interchanges for highways 410 and 407 offers optimal connectivity throughout the GTA and across the border.

8000 Dixie is unsurpassed in terms of location, configuration, flexibility, and labour — a truly premium offering.



INDUSTRIAL FOR LEASE | 8000 DIXIE RD, BRAMPTON ON

PANATTONI[®] CBRE

PREMIUM DESIGN

A

CLASS
DEVELOPMENT



FLEXIBLE
CONFIGURATION



TRAILER
PARKING
AVAILABLE



OUTSIDE
STORAGE



CORPORATE
SIGNAGE



TARGETING LEED
CERTIFICATION



SITE PLAN

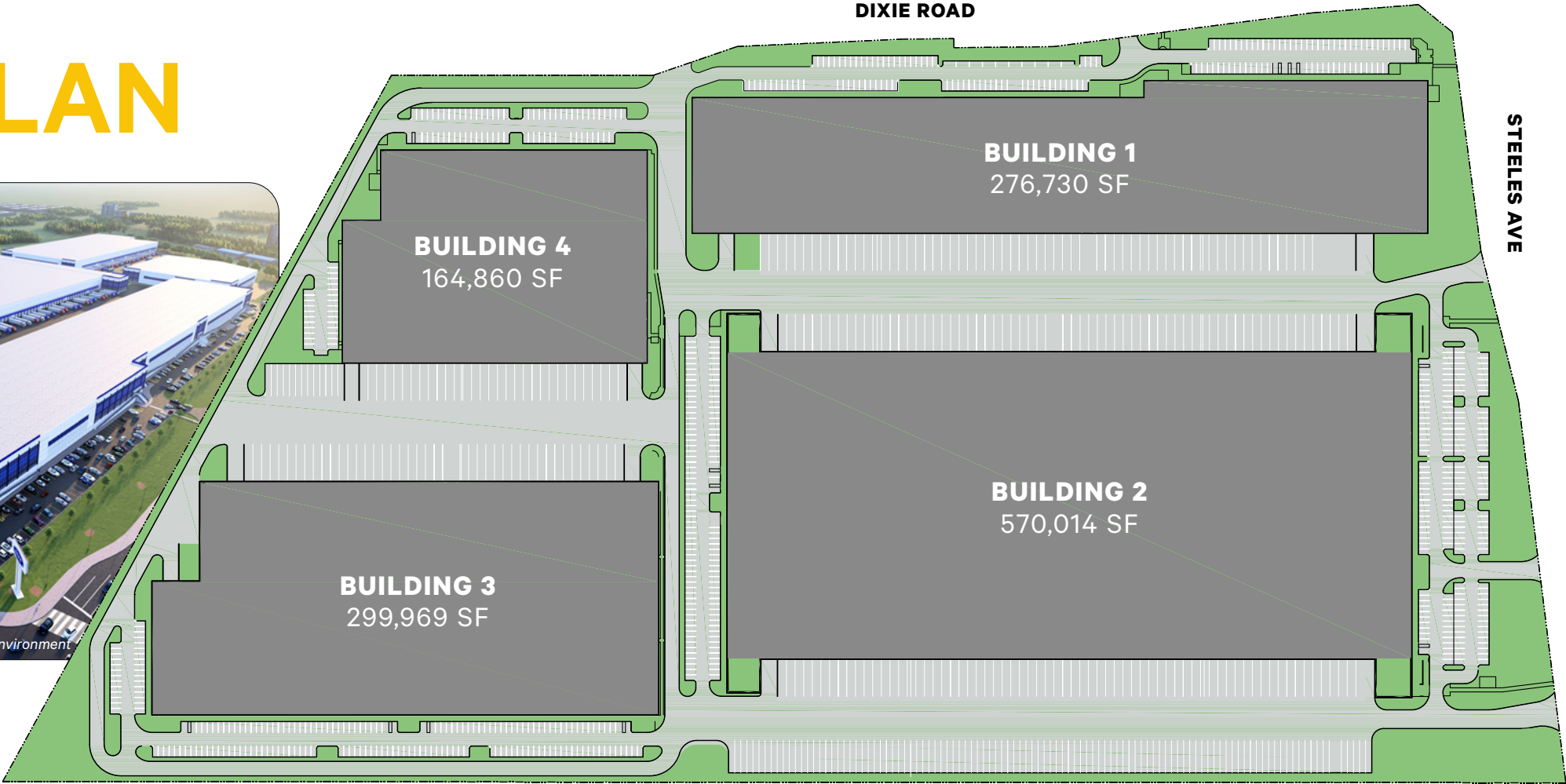

BUILDING SPECIFICATIONS:

	SIZE (SF)	CLEAR HEIGHT	BLDG DEPTH	SHIPPING	BAY SIZE	SHIPPING COURT	CAR PARKING	TRAILER STALLS	POWER
BUILDING 1	276,730	36'	221'-249'	64 TL, 2 DI	46' x 56'	138'	175	0	2,500A
BUILDING 2	570,014	40'	500'	120 TL, 4DI	42 ' x 56'	138'	337	89	3,000A
BUILDING 3	299,969	40'	380'	41 TL, 3 DI	45' x 56'	131'	187	13	2,500A
BUILDING 4	164,860	36'	347'	29 TL, 2 DI	42' x 56'	131'	98	13	1,600A

LOCATION + CONNECTIVITY

Situated at the intersection of Dixie Road and Steeles Avenue East, the site offers superior connectivity to the 410 and 407, with interchanges to both highways located just minutes down Dixie or Steeles. These highways offer connections to all 400 series highways, providing ease of access across the GTA.

Given its location, the property is ideally positioned to capitalize on continued e-commerce growth. The property can leverage Brampton’s excellent labour pool in addition to being well connected to other major labour markets in the area, such as that of Mississauga and Vaughan.

The development site is also a convenient distance from the Brampton CN and Vaughan CP intermodal and has potential for future rail access.

UNMATCHED TRANSIT CONNECTIVITY

8000 Dixie is located adjacent to Zum Brampton Transit extending all the way east offering connections to Viva (York Region). Bramalea GO Station is a 10-minute bus ride or 5-minute drive from the site offering connections all throughout the GTA. 8000 Dixie’s connectivity will be further bolstered with the near completion of the Hurontario LRT and future Finch West LRT.

DEMOGRAPHICS

RADIUS	10 KM	20 KM	30 KM
IN THE LABOUR FORCE	68.1%	66.6%	67.9%
ESTIMATED POPULATION	759,757	2,498,711	4,593,741
AVG. HOUSEHOLD INCOME	\$140,064	\$137,200	\$145,100

Source: CBRE Research 2023

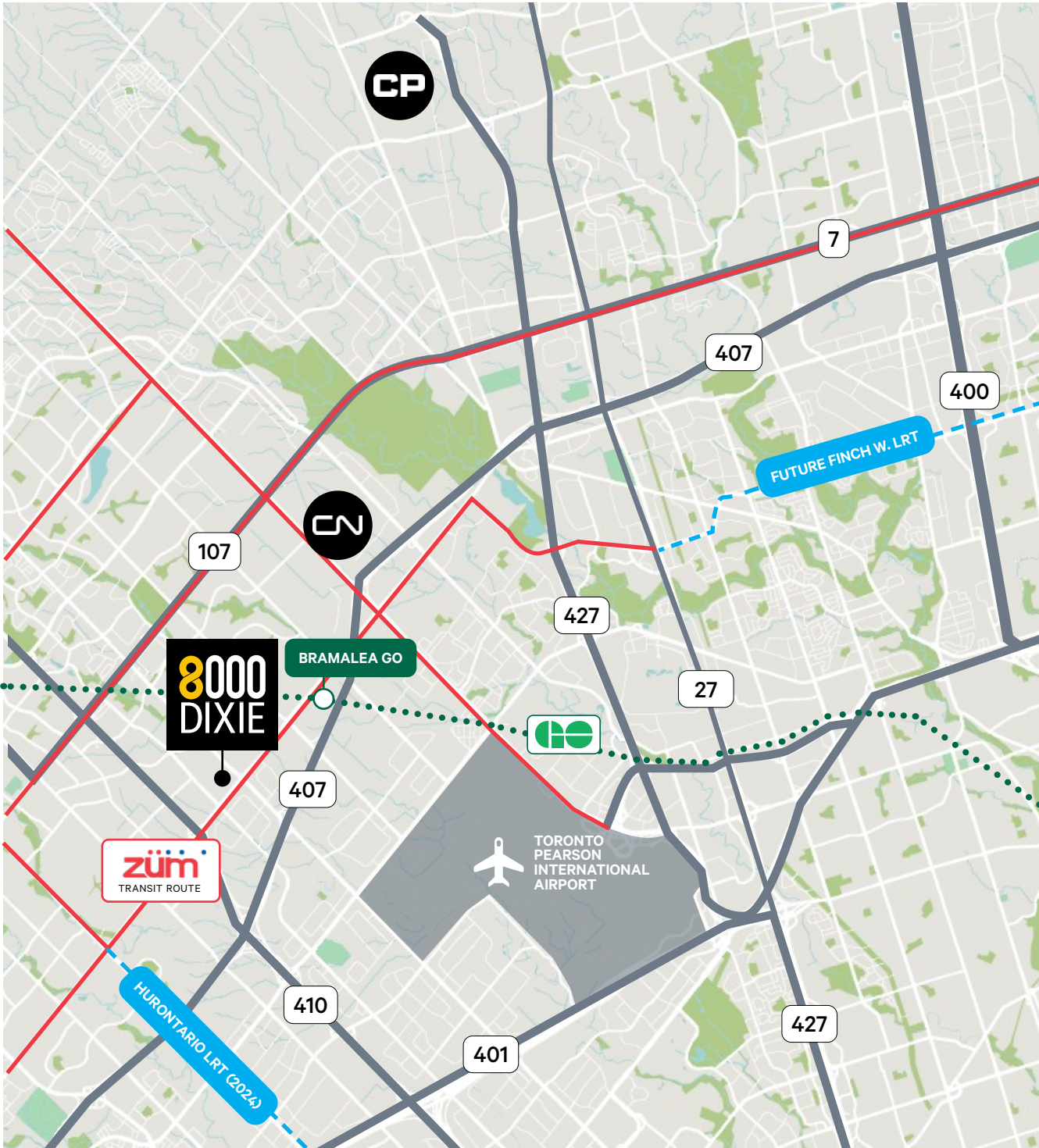

DRIVE TIMES (MINUTES)
5
HWY 410
5
HWY 407
10
HWY 401
10
CN BRAMPTON YARD
18
PEARSON AIRPORT
25
CP RAILWAY VAUGHAN
38
DOWNTOWN TORONTO
80
US BORDER

ABUNDANT + EXCEPTIONAL BRAMPTON LABOUR

8000 Dixie benefits from a diverse and robust labour market, with Brampton ranking first place in the GTA with 96/100 in Overall Industrial Labour Score.

#1

OVERALL LABOUR RANKING
IN GTA (96/100)

#1

SHARE OF INDUSTRIAL WORKERS
IN OVERALL WORKFORCE (24.8%)

#1

IN NUMBER OF INDUSTRIAL
WORKERS (SUBURBAN GTA)

NUMBER OF INDUSTRIAL WORKERS (CORE TORONTO + SUBURBS)

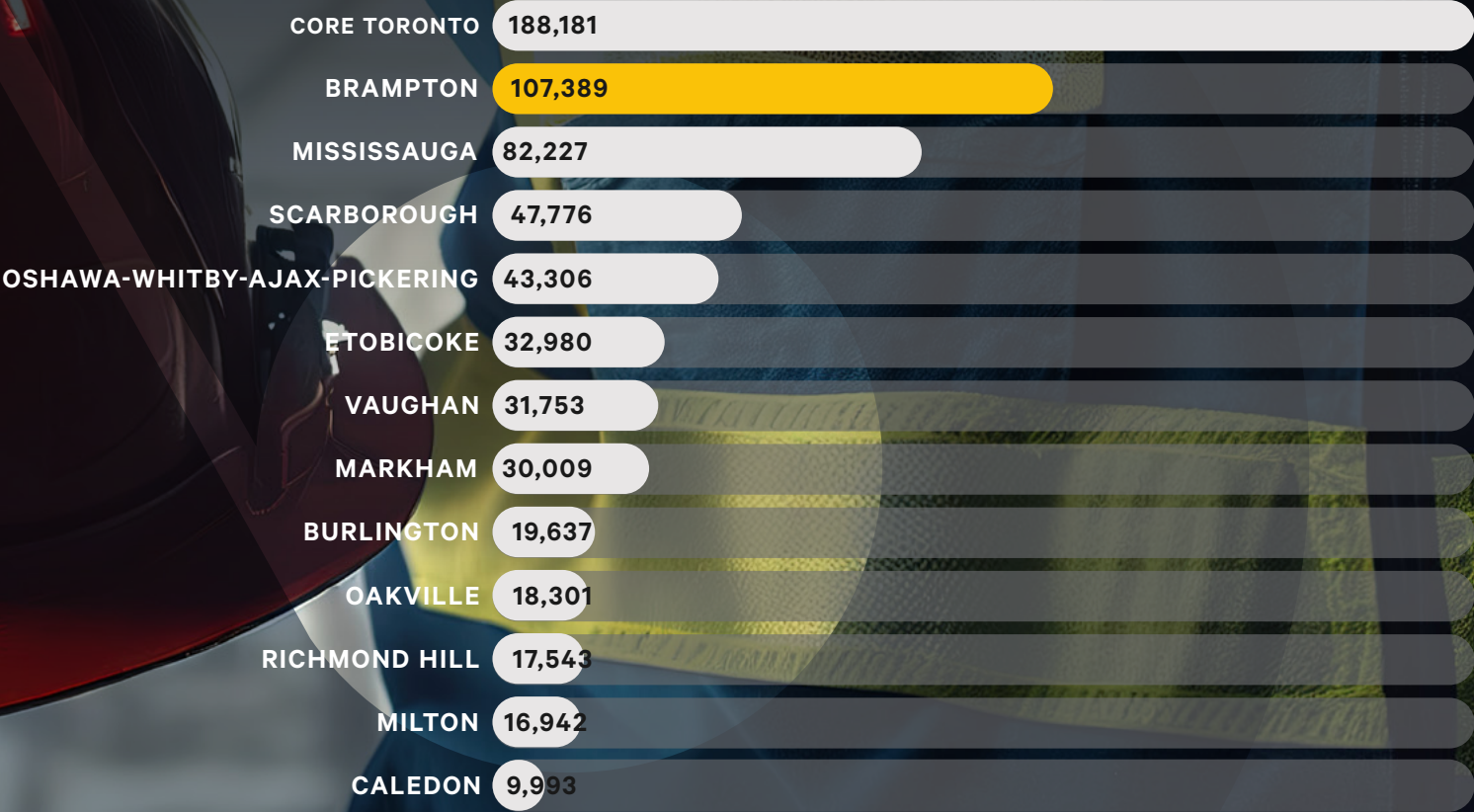

NEARBY AMENITIES + CORPORATE NEIGHBOURS



TRUSTED PARTNERS

Panattoni Development Company is one of the largest privately held, full-service real estate development companies in the world. With an expansive international platform, Panattoni specializes in industrial and build-to-suit developments. Their offices all over the world are responsible for the development of over 610 million square feet. Each office is rooted in the local community with strong partnerships that produce results for their clients in each region.

Panattoni has a proven international track record in the development and management of industrial, office, and build-to-suit projects. While enjoying the benefits of an international development firm, operational and financial responsibilities reside at the local market level. The local presence is a key success factor for the company, providing in-depth local market knowledge and relationships and generating a wide base of business opportunities.





CONTACT US FOR MORE INFORMATION:

JONATHAN LEARY*
Executive Vice President
+1 905 315 3695
jonathan.leary@cbre.com

SCOT STEELE*
Executive Vice President
+1 416 798 6221
scot.steele@cbre.com

MAX LEWIS
Sales Representative
+1 905 315 3692
max.lewis@cbre.com



CBRE Limited, Real Estate Brokerage | 1235 North Service Road West, Suite 101 | Oakville, ON L6M 2W2

*Sales Representative

© CBRE, Inc. This disclaimer shall apply to CBRE Limited, Real Estate Brokerage, and to all other divisions of the Corporation, to include all employees and independent contractors ("CBRE"). The information set out herein, including, without limitation, any projections, images, opinions, assumptions and estimates obtained from third parties (the "Information") has not been verified by CBRE, and CBRE does not represent, warrant or guarantee the accuracy, correctness and completeness of the Information. CBRE does not accept or assume any responsibility or liability, direct or consequential, for the Information or the recipient's reliance upon the Information. The recipient of the Information should take such steps as the recipient may deem necessary to verify the Information prior to placing any reliance upon the Information. The Information may change and any property described in the Information may be withdrawn from the market at any time without notice or obligation to the recipient from CBRE. CBRE and the CBRE logo are the service marks of CBRE Limited and/or its affiliated or related companies in other countries. All other marks displayed on this document are the property of their respective owners. All Rights Reserved. Mapping Sources: Canadian Mapping Services canadamapping@cbre.com, DMTI Spatial, Environics Analytics, Microsoft Bing, Google Earth.