

90 WHYBANK DRIVE, UNIT 3

BRAMPTON, ONTARIO

43,633 SQ. FT. FOR LEASE



AVAILABLE IMMEDIATELY



HIGHWAY 410 ACCESS



PANATTONI®

CAP Inc.
ONTARIO

PROPERTY HIGHLIGHTS

 **Size**
43,633 Sq. Ft.

 **Bay Size**
31' 5" x 47' .24"

 **Highways**
Close access to
Hwys 410 & 407

 **Clear Height**
28'

 **Shipping**
5 TL; 1 DI

 **Available**
Immediately



SITE PLAN

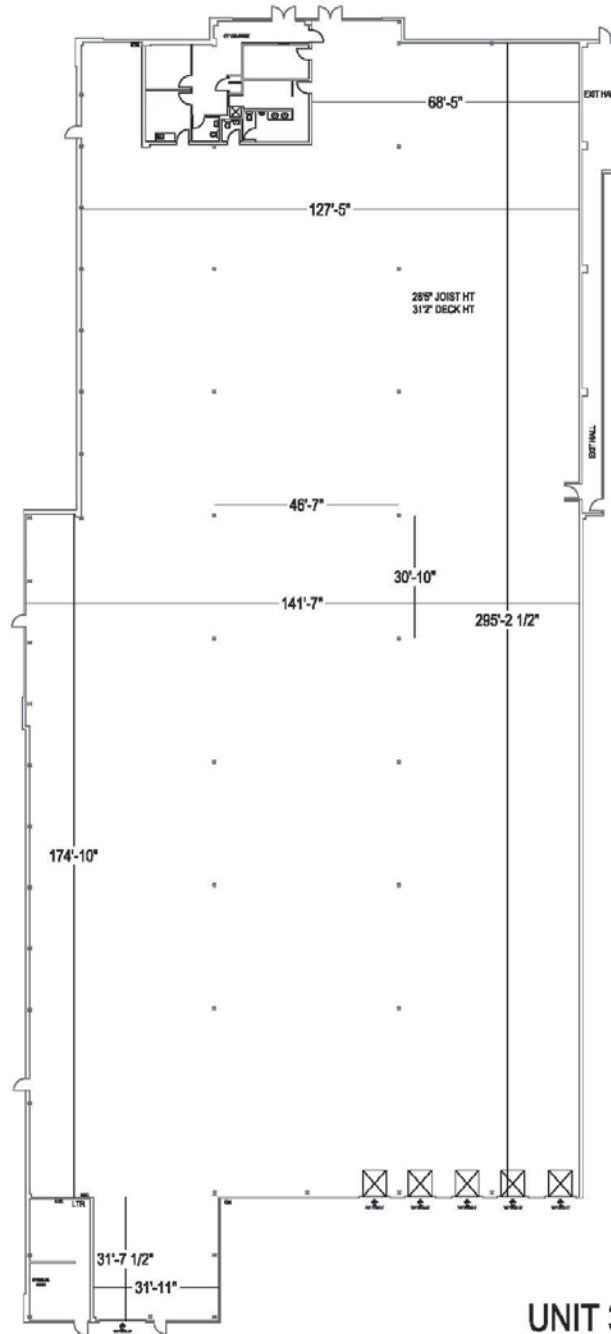

UNIT 3
OFFICE: 1,310 SF
WAREHOUSE: 42,323 SF
TOTAL AREA: 43,633 SF

INTERIOR PHOTOS

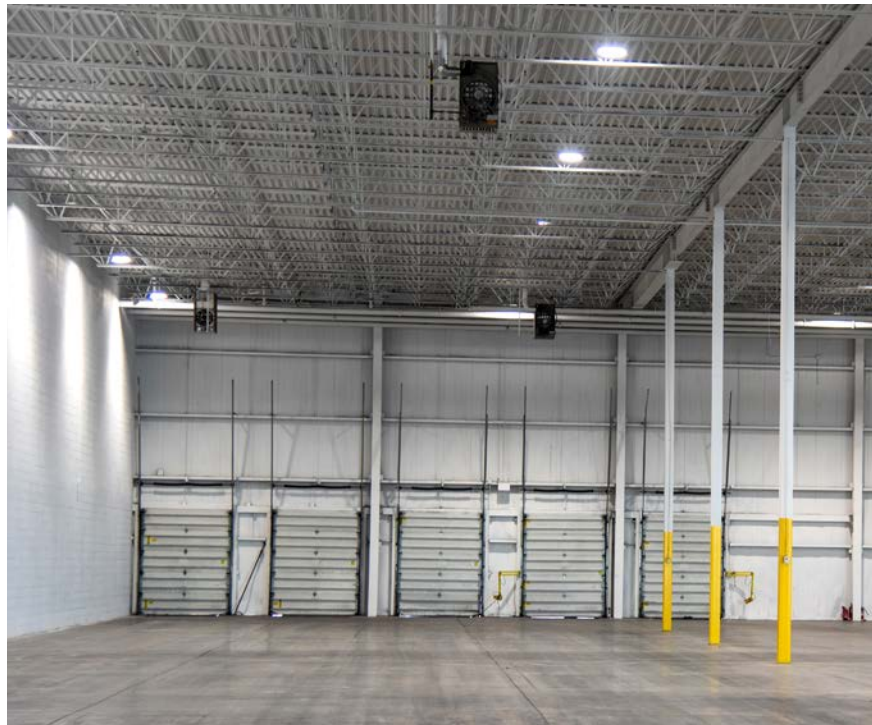

PHOTOS

EXTERIOR PHOTOS



CONVENIENT TRANSPORTATION ROUTES

Highway 410
4.21 km/8 mins

Highway 401
18.61 km/17 mins

CN Brampton Yard
15.74 km/21 mins

Pearson International Airport
23.07 km/23 mins

Highway 407
14.40 km/15 mins

Highway 427
19.52 km/21 mins

CP Vaughan Yard
17.11 km/33 mins

Downtown Toronto
47.4 km/40 mins

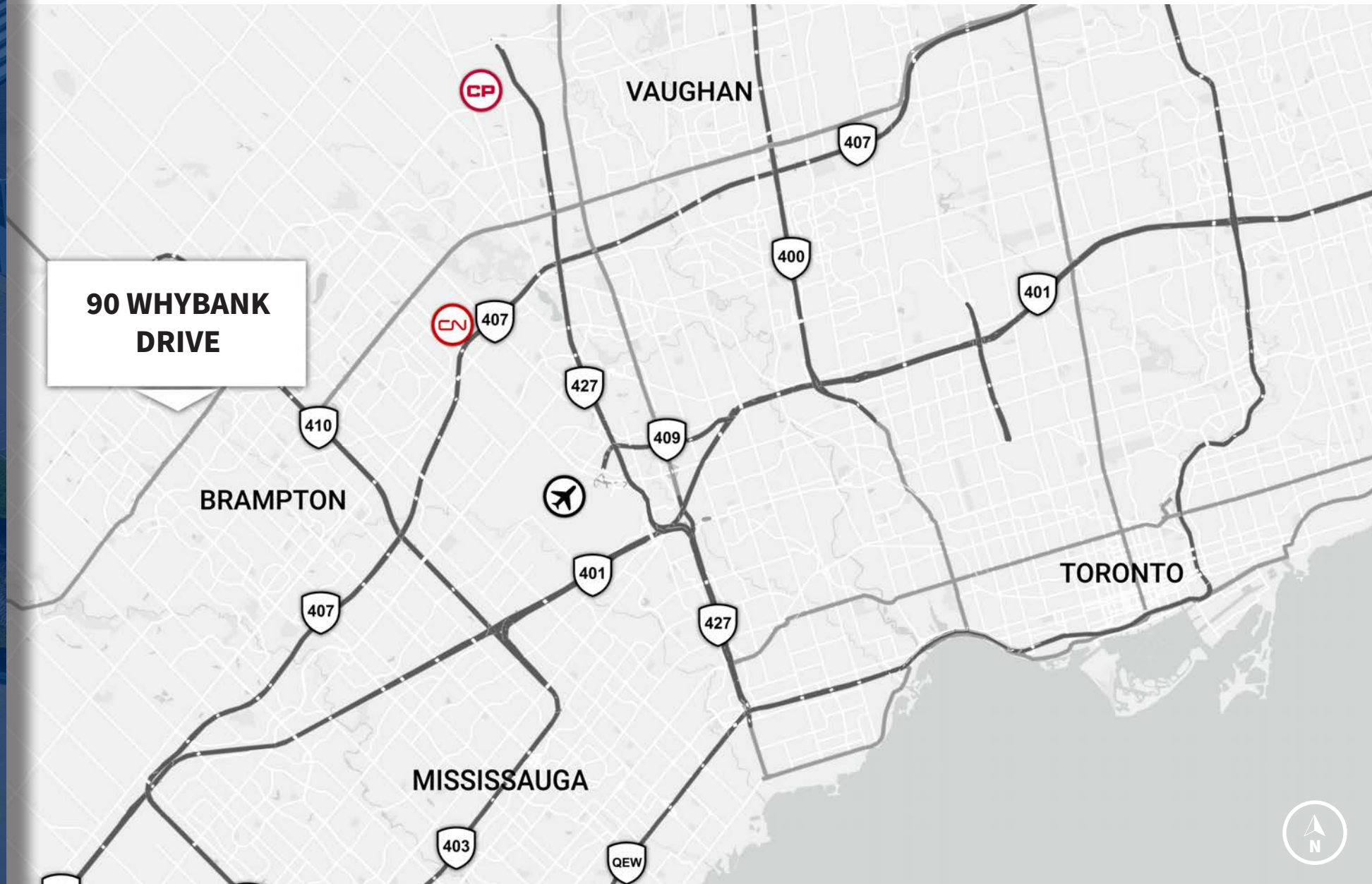

CONVENIENT PUBLIC TRANSIT ROUTES

- Kitchener Go Line
- 501 Züm Queen
- 502 Züm Main
- 505 Züm Bovaird
- 4 Chinguacousy
- 23 Sandalwood
- 24 Van Kirk
- 29 Williams



TRANSIT OVERVIEW

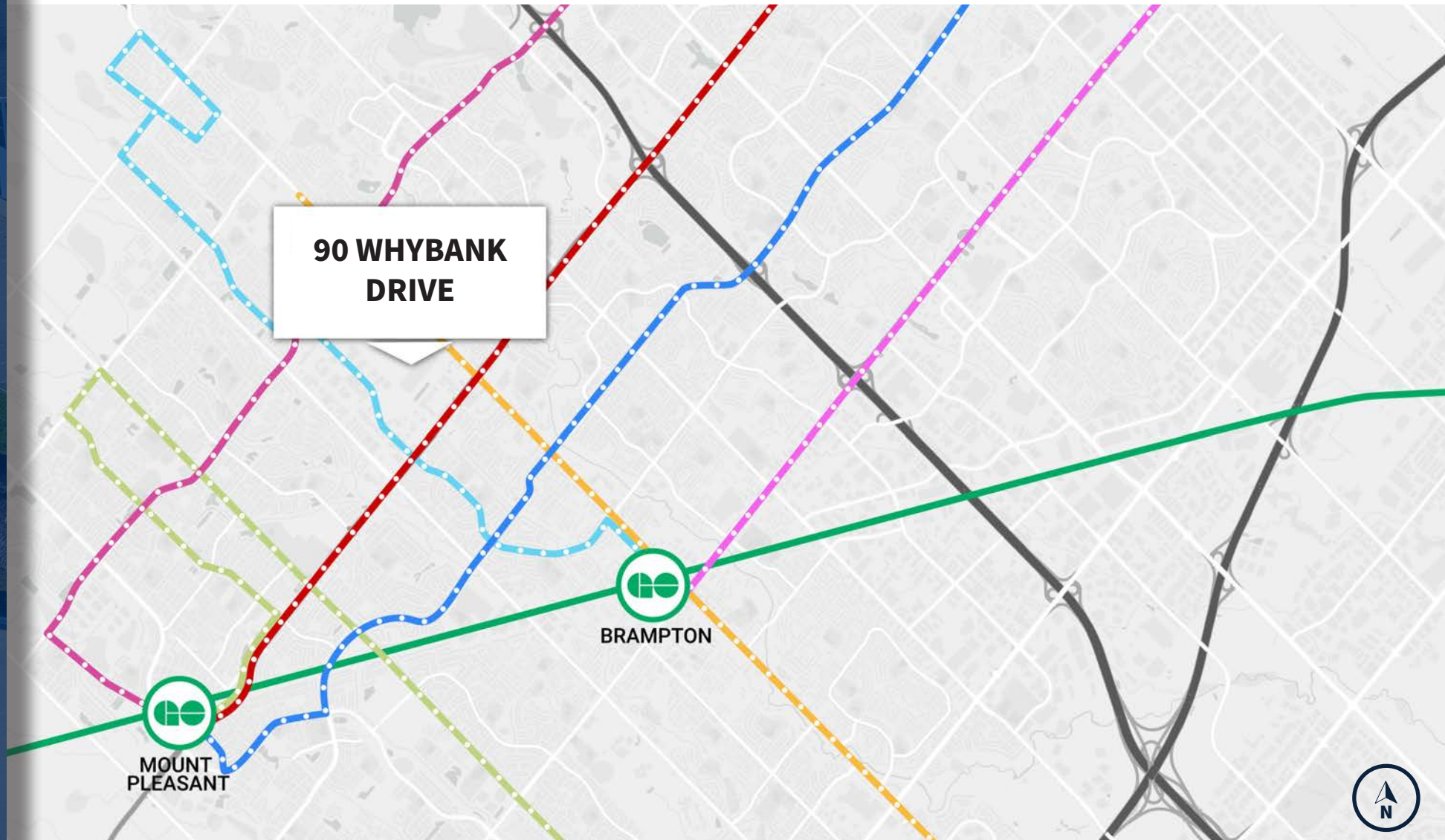

BRAMPTON'S GROWING POPULATION

- Brampton has access to a labour pool of 4.3M people across the GTA.
- Brampton is the second fastest growing city in Canada and home to the largest intermodal terminal in Canada.
- Located in the middle of the Toronto-Waterloo Corridor, Brampton is in close proximity to all 400 series highways accessing 158 million consumers.
- The Transportation and Warehousing Industry accounts for 11.5% of the total active labour force.

DEMOGRAPHICS



90 WHYBANK DRIVE, UNIT 3

BRAMPTON, ONTARIO

43,633 SQ. FT. FOR LEASE



FOR MORE INFORMATION:

SARAH SMELE, Leasing Manager
CAP Ontario Inc.
416-915-1994
ssmele@capproperties.ca



No warranty or representation, expressed or implied, is made as to the accuracy of the information contained herein, and same is submitted subject to errors, omissions, change of price, rental or other conditions, withdrawal without notice, and to any specific marketing condition, imposed by our principals.